

2024 FT 1000x500mm



- ❖ Full Front Service
- ❖ Magnetic Module Design
- ❖ High Flatness Design
- ❖ Ultra Light and Thin
- ❖ 1.9 and 2.6mm Pixel Pitches

2024 FT 1000x500mm

Multiple installation styles



Wall-mounted

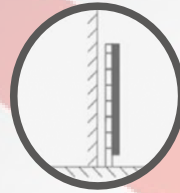

Ground stacking



Truss rigging

Power supply Receive Card Cabinet Locks

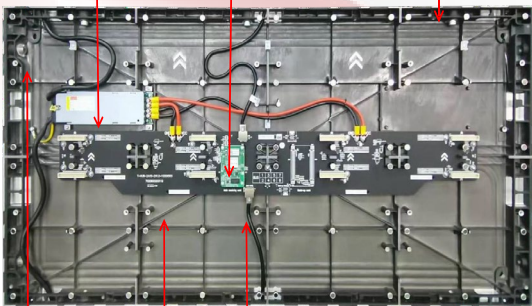

Cabinet Locks HUB card Signal port Mounting Hole

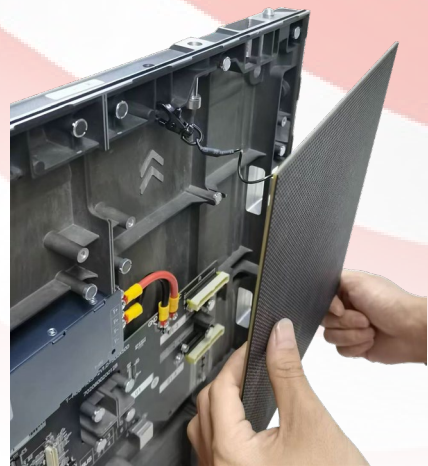

- ❖ Cableless Design
- ❖ Magnetic Modules with Safety Rope

1000 x 500mm cabinet

2024 FT 1000x500mm

Specifications

Model	FT1.9	FT2.6
Pixel Pitch (mm)	1.95mm	2.6mm
Pixel Density (dot/sqm)	262,144	147,456
LED Type	SMD1212	SMD1515
Module Resolution (pixels)	128x128	96x96
Module Dimension (mm)	250x250	250x250
Module Weight (kgs)	.36	.33
Viewing Angle (H/V)	160/160	
Brightness (nits)	800-1000	
Gray Scale (bit)	14	
Refresh Rate (Hz)	3840	
Cabinet Size (mm)	1000x500	
Cabinet Weight (kg)	18.5kgs/Sqm	18kgs/Sqm
Cabinet Thickness (mm)	30mm	
Maximum Power (W/Sqm)	435±3%/Sqm	400±3%/Sqm
Average Power (W/Sqm)	130W/Sqm	120W/Sqm
Input Voltage (v)	AC100-240V	
Working Temperature (°C)	-20~+50°C	
Working Humidity (RH)	10%~98%RH	
Storage Temperature (°C)	-30~+60°C	
Storage Humidity (RH)	10%~60%RH	
Ingress Protection	IP20	
Installation Method	Full Front Service	
Certificates	CE (EMC A,LVD), FCC, ETL	